

SM1000-2 PARTS LISTING

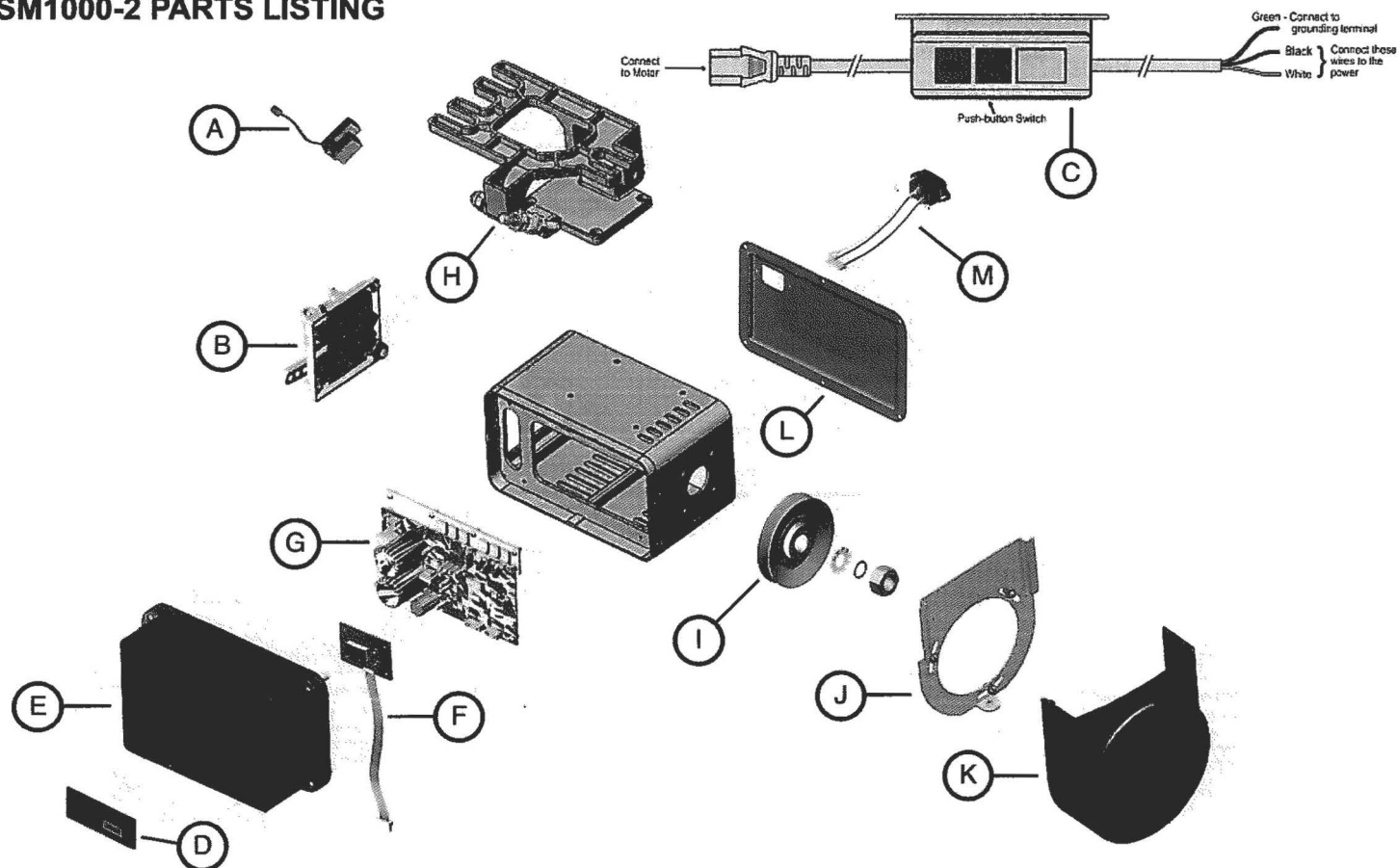

No.	Fig.	Description
-----	------	-------------

SM68	A	Sensor only with screws (single channel for non-positioner motor)
SM103	B	Treadle sensor plate assembly complete with 4 screws (single channel for non-positioner motor) (877C)
SM78	C	Complete horizontal wire harness for 220 volt models (431C)
SM105	D	SM1000-2 label
SM108	E	SM1000 Elite control box cover with 4 screws (431C Matte)
SM109	F	4 Digit LED display with screws
SM110	G	SM1000-2 circuit board with 6 Screws
SM113	H	Motor mounting bracket complete with 4 screws (877C)
SM50	I	50mm pulley with mounting hardware
SM60	I	60mm pulley with mounting hardware
SM75	I	75mm pulley with mounting hardware
SM80	I	80mm pulley with mounting hardware
SM90	I	90mm pulley with mounting hardware
SM100	I	100mm pulley with mounting hardware
SM79	J	Pulley cover bracket with screws and washers
SM86	K	Pulley cover with screw and washer (431C Matte)
SM115	L	Rear motor cover panel SM1000-2 with 6 screws (877C)
SM81	M	Power inlet receptacle with wires, terminals and screws complete